

Fail safe Silt Fence on 3m OD contour
See 18112-C92

Hedge to be removed temporarily to facilitate separate and safe access
Location and design to be agreed with Roads Authority

Adequate Sight Distances Along R510 and cycle track
Appropriate traffic controls to be put in place by contractor

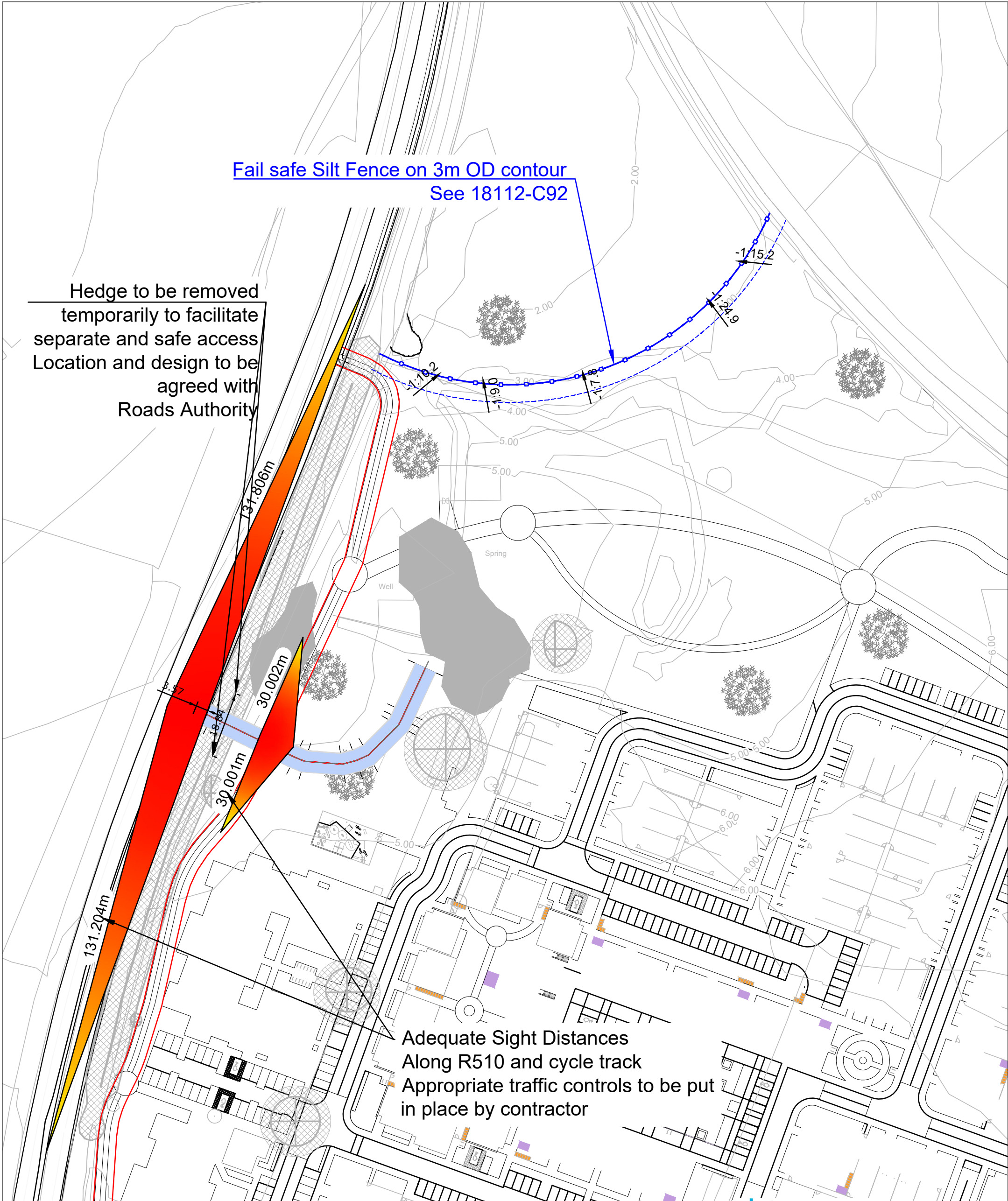

REVISION DETAILS	DATE	NOTES
B Update compound	17.12.21	

© HUTCH O'MALLEY MCBEATH CONSULTING ENGINEERS
THIS DRAWING AND ANY DESIGN HEREON IS THE COPYRIGHT OF THE CONSULTANTS AND MUST NOT BE REPRODUCED WITHOUT THEIR WRITTEN CONSENT.
ALL DRAWINGS REMAIN THE PROPERTY OF THE CONSULTANTS. ALL DIMENSIONS TO BE VERIFIED AND CHECKED ON SITE. CONSULTANTS TO BE INFORMED OF ANY DISCREPANCIES BEFORE WORK PROCEEDS.

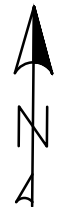

Hutch O'Malley Consulting Engineers The Railway Station, Attyflin, Patrickswell, Co.Limerick E-Mail: admin@hutchomalleymcbeath.ie Phone: 061-320260			
Project Number:	Drawing Number:	Revision Number:	
18112	C37	B	
Drawn:	Scale:	Checked:	Date:
DOM	1:1000	DOM	9/11/2021

Issue:	PLANNING
Project:	SHD Raheen
Client:	DW RAHEEN
Drawing Title:	Construction Access and Compound